



Switzerland.



Switzerland.

The V-cableway project – half a billion investment into quality and the future.

with Dario Gross



Switzerland.

Switzerland update.

What is open and when: [MySwitzerland.com/where-and-when-is-what-open](https://www.myswitzerland.com/where-and-when-is-what-open)

Updates on public transportation: www.mystsnet.com/en/news/corona/

Clean & Safe label: www.clean-and-safe.ch



Our Trade Team in North America.

New York



Paolo Lunardi



Florin Eggenberger

San Francisco



Mirko Capodanno

Toronto



Pascal Prinz

Swiss Travel System



Martin Oester



Isabelle Rapisarda

nyc.trade@switzerland.com / 1-800-794-7795 option 3

www.myswitzerland.com/trade-us

Win a Swiss Surprise Box.



Switzerland.

Are you the Winner?

- 1. Which Swiss castle is located a few minutes away from Montreux at Lake Geneva?**
- 2. What is the name of the new cable car from Grindelwald Terminal to Eigergletscher opening on December 5, 2020?**
 - a) Jungfrau Express
 - b) Eiger Express
 - c) Jungfrauoch Express
- 3. How high above sea level is the highest train station in Europe the Jungfrauoch – Top of Europe?**
 - a) 11,332 ft
 - b) 9,600 ft
 - c) 10,963 ft

Send your answers to nyc.trade@switzerland.com by Monday, August 17th, 2020

E-Learning: “Switzerland Travel Academy”.

Complete six core modules in order to become a certified Switzerland travel expert and specialize in specific topics such Swiss travel products, regions & destinations:

www.northamerica.switzerlandtravelacademy.ch

Switzerland in 3, 5 or 10 days

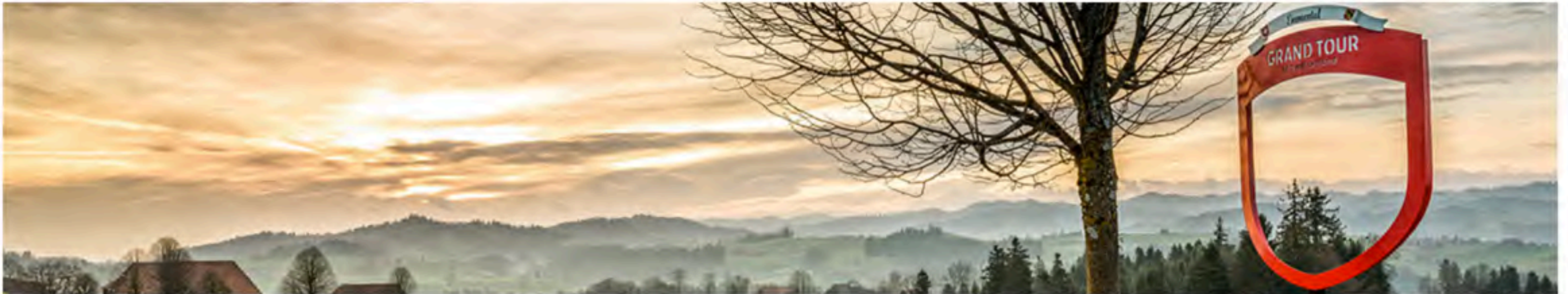

Graduate before Nov. 30, 2020 for a chance to **win a flight for two to Switzerland.**





Switzerland.

Switzerland's castles.

- Behind these ancient walls lie hidden treasures and fascinating stories!
- A visit to a castle always forms part of an overall experience - as a destination of a walk or a boat trip or the highlight of a city tour e.g. Spiez Castle, the three Castles of Bellinzona or the Chillon Castle.
- Get inspired on our website here:
www.myswitzerland.com/en-us/experiences/summer-autumn/the-swiss-castles/



Chillon Castle © Markus Buehler-Pasom.

Belvedere Swiss Quality Hotel Grindelwald****



The Hotel Belvedere has been owned by the family since its first opening in 1907 and is now managed personally by the 3rd and 4th generations of the Hauser family. Located not far from the center of Grindelwald on its own sun terrace, it offers unique views of the world-famous Eiger.

- 56 rooms
- Spa area
- Seminar rooms



Belvedere Swiss Quality Hotel Grindelwald****



Swiss Family Hotels & Lodging

Contact and further information:

- +41 (0)33 888 99 99
- www.belvedere-grindelwald.ch/en/
- hotel@belvedere-grindelwald.ch



JUNGFRAU RAILWAYS





JUNGFRAU
TOP OF EUROPE

AMSTERDAM

BERLIN

PARIS

VIENNA

MUNICH

JUNGFRAU
TOP OF EUROPE

MILAN

ROME

BARCELONA

JUNGFRAU
TOP OF EUROPE

PARIS, AMSTERDAM

BERLIN, MUNICH

✈ BASEL

✈ ZURICH

VIENNA

LUCERNE

BERN

INTERLAKEN
JUNGFRAU
TOP OF EUROPE

BRIG

MONTREUX

✈ GENEVA

BARCELONA, PARIS

ZERMATT

✈ LUGANO

MILAN, ROME



JUNGFRAU

TOP OF EUROPE



JUNGFRAU
TOP OF EUROPE



JUNGFRAUJOCH

JUNGFRAU SKI REGION

EIGERGLETSCHER

KLEINE SCHEIDEGG

GRINDELWALD

GRINDELWALD-FIRST

GRINDELWALD TERMINAL

WENGEN

LAUTERBRUNNEN

SCHYNIGE PLATTE

WILDERSWIL

INTERLAKEN OST

HARDER KULM

JUNGFRAU
TOP OF EUROPE

GRINDELWALD

GRINDELWALD TERMINAL

12 mi / 23 min

Bernese Oberland Railway

365 days a year

LAUTERBRUNNEN

8 mi / 20 min

INTERLAKEN OST

JUNGFRAU
TOP OF EUROPE

EIGERGLETSCHER

4 mi / 15 min

GRINDELWALD TERMINAL

Eiger Express

📅 365 days a year

JUNGFRAU
TOP OF EUROPE

JUNGFRAUJOCH

6 mi / 35 min

EIGERGLETSCHER

KLEINE SCHEIDEGG



Jungfrau Railway

📅 365 days a year

JUNGFRAU
TOP OF EUROPE



New, ultra-modern aerial gondolas

Journey time
47 minutes quicker

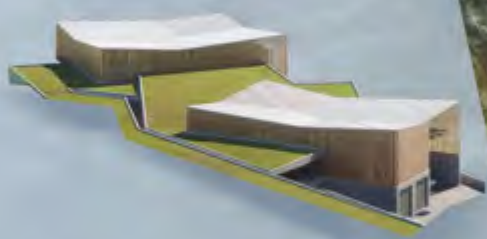

Best Terminal

In the Alps with shops, food
and direct public transport links

EIGER

JUNGFRAUJOCH - TOP OF EUROPE

EIGERGLETSCHER

MÄNNLICHEN

GRINDELWALD TERMINAL





Grindelwald Terminal

3,074 FMSL From 14 December 2019 all year round

JUNGFRAU
TOP OF EUROPE



Grindelwald Terminal

3,074 FMSL From 14 December 2019 all year round



JUNGFRAU
TOP OF EUROPE



SOUVENIRS

Münichenerbahn
GRINDELWALD

Grindelwald Terminal

3,074 FMSL From 14 December 2019 all year round

JUNGFRAU

TOP OF EUROPE

Eiger Express



Eiger Express

7,638 FMSL



From 5 December 2020 all year round

JUNGFRAU
TOP OF EUROPE

Aufbahn Depart Parterre

Bei gemessenen Grenzwertüberschreitungen
an Luftschadstoffen wird das Seilbahnkabinen-
system gestoppt.

Eiger Express

Eiger Express

7,638 FAMS

From 5 December 2020 all year round

JUNGFRAU
TOP OF EUROPE

Eiger Express



Eiger Express

7,638 FMSL



From 5 December 2020 all year round

JUNGFRAU
TOP OF EUROPE

GRINDELWALD

KLEINE SCHEIDEGG



Wengernalp Railway

📅 365 days a year

WENGEN

7 mi / 42 min

LAUTERBRUNNEN

JUNGFRAU
TOP OF EUROPE



Train journey to Europe's highest railway station

11,332 FMSL 365 days a year



Sphinx vantage platform

11,716 FMSL 365 days a year



Mönchsjochhütte

11,975 FMSL  Staffed until the end of October

JUNGFRAU

TOP OF EUROPE



Ice Palace

11,332 FMSL 📅 365 days a year

JUNGFRAU
TOP OF EUROPE

11,332 FAMSL 365 days a year

EXCLUSIVE

Ice Bar

In the Ice Bar, groups of up to 25 people can enjoy an aperitif, with two different options. The Ice Bar is located in the middle of the Ice Palace and can be booked exclusively on request.

Aperitif options

Aperitif 1: Classic "Top of Europe"

Fendant du Valais AOC "Top of Europe" white wine and Armaville champagne, beer, orange juice and glacier water, homemade cheesecake and puff pastries, smoked salmon and beef tartar open sandwiches.

Aperitif 2: "Ice Label"

Fendant du Valais AOC "Top of Europe" white wine and "Ice Label" Swiss highland single malt whiskey, orange juice and glacier water, homemade puff pastries

Ice Bar rent including aperitif (45 mins.) up to 25 people **CHF 1100.00 per group (flat rate)**

Train journey not included in the price. All prices in CHF including 7.7% VAT.

JUNGFRAU
TOP OF EUROPE



Glacier plateau

11,332 FMSL 365 days a year



Lindt Swiss Chocolate Heaven

11,332 FAMSL 365 days a year

JUNGFRAU

TOP OF EUROPE

Restaurant Crystal

11,332 FAMSL 365 days a year



Good Morning Ticket Jungfrauoch

The awakening mountain world offers a very special spectacle: in the distance, the first rays of sunlight are visible on the mountain peaks, while the meadows in the valley still lie in their quiet slumber. It pays to get up early.

With this ticket, the journey from Kleine Scheidegg to Jungfrauoch is only possible at 8.00 and 8.30, and the latest descent from Jungfrauoch is at 13.13.

Route 1

Lauterbrunnen ↔ Jungfrauoch ↔ Grindelwald Grund

95.–
per person

Route 2

Interlaken Ost ↔ Jungfrauoch

95.–
per person

Route 3

Grindelwald → Jungfrauoch → Lauterbrunnen

95.–
per person

JUNGFRAU
TOP OF EUROPE



Coming soon: Gletscher Adventure Trail

JUNGFRAU
TOP OF EUROPE

3 mi / 25 min

GRINDELWALD

GRINDELWALD-FIRST



First Railway

📅 6 June 2020 – autumn 2021

JUNGFRAU
TOP OF EUROPE



Firstbahn

7,113 FMSL 6.6.2020 – autumn 2021

JUNGFRAU
TOP OF EUROPE



Hike to Bachalpsee

7,431 FMSL



Summer and winter



First Cliff Walk presented by Tissot

7,113 FMSL 6.6.2020 – autumn 2021

JUNGFRAU
TOP OF EUROPE

First Flyer

7,113 FMSL 6.6.2020 – autumn 2021

JUNGFRAU
TOP OF EUROPE



First Glider

7,113 FMSL 6.6.2020 – autumn 2021

JUNGFRAU
TOP OF EUROPE



First Mountain Cart

6,407 FMSL 6.6.2020 – autumn 2021



Trottibike scooter

🏔️ 5,121 FMSL 📅 6.6.2020 – 25.10.2020



Adventure Package

The choice is yours. Put your Adventure Package together. When you buy this offer, set the desired number of activities and then decide your favourite(s) when you are on the mountain. The aerial gondola can be used for unlimited trips.

<div>1 ACTIVITY</div>				
<div>2 ACTIVITIES</div>	<div> Adults (from 16 years)</div>	<div> Half-fare card, GA, Swiss Travel Pass</div>	<div> Children (6-15 years*)</div>	
<div>3 ACTIVITIES</div>	<div>Individual travellers</div>	<div>120.-</div>	<div>99.-</div>	<div>84.-</div>
<div> + <div>4 ACTIVITIES</div></div>	<div>Groups 10 Persons+</div>	<div>99.-</div>	<div>-</div>	<div>84.-</div>

No reimbursement with the Adventure if some activities are suspended. No free rides. All prices in CHF including 7.7% VAT.

JUNGFRAU
TOP OF EUROPE



Harder Railway

📅 6 June to 29 November 2020

INTERLAKEN OST

1 mi / 10 min

HARDER KULM



Harder Railway

4,337 FMSL 6.6. – 29.11.2020



Harder Kulm Panorama Restaurant

4,337 FMSL 6.6. – 29.11.2020

Harder Folklore back in 2021



Harder folklore

4,337 FAMSL Back in 2021

JUNGFRAU
TOP OF EUROPE



Jungfrau Travel Pass

3 to 8 days unlimited travel - Groups/FIT

3	4	5 Days	6	7	8
---	---	--------	---	---	---

Adults
(from 16 years)

Half-fare card, GA,
Swiss Travel Pass

Children
(6-15 years*)

	Adults (from 16 years)	Half-fare card, GA, Swiss Travel Pass	Children (6-15 years*)
B2C	250.-	190.-	30.-
B2B	200.-	152.-	30.-

Connecting ticket

Eigergletscher → Jungfrauoch → Eigergletscher

Season 1 CHF 61.-

Season 2 CHF 74.-

Jan	Feb	Mar	Apr	May	Jun	Jul	Aug	Sep	Oct	Nov	Dec
-----	-----	-----	-----	-----	-----	-----	-----	-----	-----	-----	-----

All prices in CHF including 7.7% VAT. Valid from 6 June to 25 October 2020.

JUNGFRAU
TOP OF EUROPE

NACHNAME / VORNAME: 14.01.17 - 21.01.17
LAND: Smith Mary
PASS/ID-NR: USA
457614768

1 .KL.

STS AG
ZÜRICH
98 001394 0311 1331
03.11.16
ARTIKEL-NR: 009837



Switzerland.
by train, bus and boat.



Swiss Travel Pass

**The best way to explore Switzerland
by train, bus and boat**

- Unlimited travel by train, bus and boat
- Available with a validity period of 3, 4, 8 or 15 days
- Up to 50% discount on mountain excursions
- With the Swiss Family Card (free), children from 6 to 15 years accompanied by at least one parent travel free.
(including Jungfrauoch - Top of Europe)



Top of Europe Flagship Store, Interlaken

 365 days a year

JUNGFRAU
TOP OF EUROPE



Dario Gross
Sales Manager
Landline: +41 33 828 72 14
Mobile: +41 79 250 35 50
dario.gross@jungfrau.ch

Thank you

 www.jungfrau.ch/sales-manual/share/471xpTSZmr3iuN4gzMjr2J





Switzerland.

Are you the Winner?

- 1. Which Swiss castle is located a few minutes away from Montreux at Lake Geneva?**
- 2. What is the name of the new cable car from Grindelwald Terminal to Eigergletscher opening on December 5, 2020?**
 - a) Jungfrau Express
 - b) Eiger Express
 - c) Jungfrauoch Express
- 3. How high above sea level is the highest train station in Europe the Jungfrauoch – Top of Europe?**
 - a) 11,332 ft
 - b) 9,600 ft
 - c) 10,963 ft

Send your answers to nyc.trade@switzerland.com by Monday, August 17th, 2020

Questions.



Switzerland.





Switzerland.

Webinar with Liechtenstein.
Join us on August 27th at 12 pm EDT.



Switzerland.